

TAP3811 – Antique style monobloc tap

Key:	Description:	APX size (mm):	Base material:	Colour:	QTY:
A1	Aerator case	35 x 19	Brass	Pewter	1
A2	Flow straightener	21 x 12	Plastic	Grey	1
A3	Rubber gasket	21 OD x 2	Rubber	Black	1
A4	Spout	280 x 205	Brass	Pewter	1
A5	Anti friction split ring	21 x 3	PTFE	White	1
A6	O-ring	16 OD x 2	Rubber	Black	1
A7	O-ring	16 OD x 2	Rubber	Black	1
A8	Spout locking collar	12 x 29 AF	Brass	Pewter	1
B1	Body	50 x 49	Brass	Pewter	1
B2	Upper seal	42 x 2	Rubber	Black	1
C1	Hot indice	14 x 7	Plastic	White	1
C2	Indice housing	18 x 7	Brass	Pewter	1
C3	Handle screw	M5 x 15	Steel	Silver	1
C4	Handle	67 x 30	Brass	Pewter	1
C5	Valve cover	25 x 29 AF	Brass	Pewter	1
C6	Hot valve	47 x 24	Brass	Brass	1
D1	Cold indice	14 x 7	Plastic	White	1
D2	Indice housing	18 x 7	Brass	Pewter	1
D3	Handle screw	M5 x 15	Steel	Silver	1
D4	Handle	67 x 30	Brass	Pewter	1
D5	Valve cover	25 x 29 AF	Brass	Pewter	1
D6	Cold valve	47 x 24	Brass	Brass	1
E1	Fixing stud	M8 x 70	Steel	Silver	1
E2	Lower gasket	44 OD	Rubber	Black	1
E3	Metal horseshoe	50 x 4	Steel	Silver	1
E4	Fixing nut	15 x 11 AF	Brass	Brass	1
F1	Cold tail pipe	245 x 15 x M12	Copper	Copper	1
F2	Hot tail pipe	245 x 15 x M12	Copper	Copper	1
X1	fixing kit assembly	N/A	N/A	N/A	1
X2	Flow straightener assembly	N/A	N/A	N/A	1
X3	Hot handle assembly	N/A	N/A	N/A	1
X4	Cold handle assembly	N/A	N/A	N/A	1

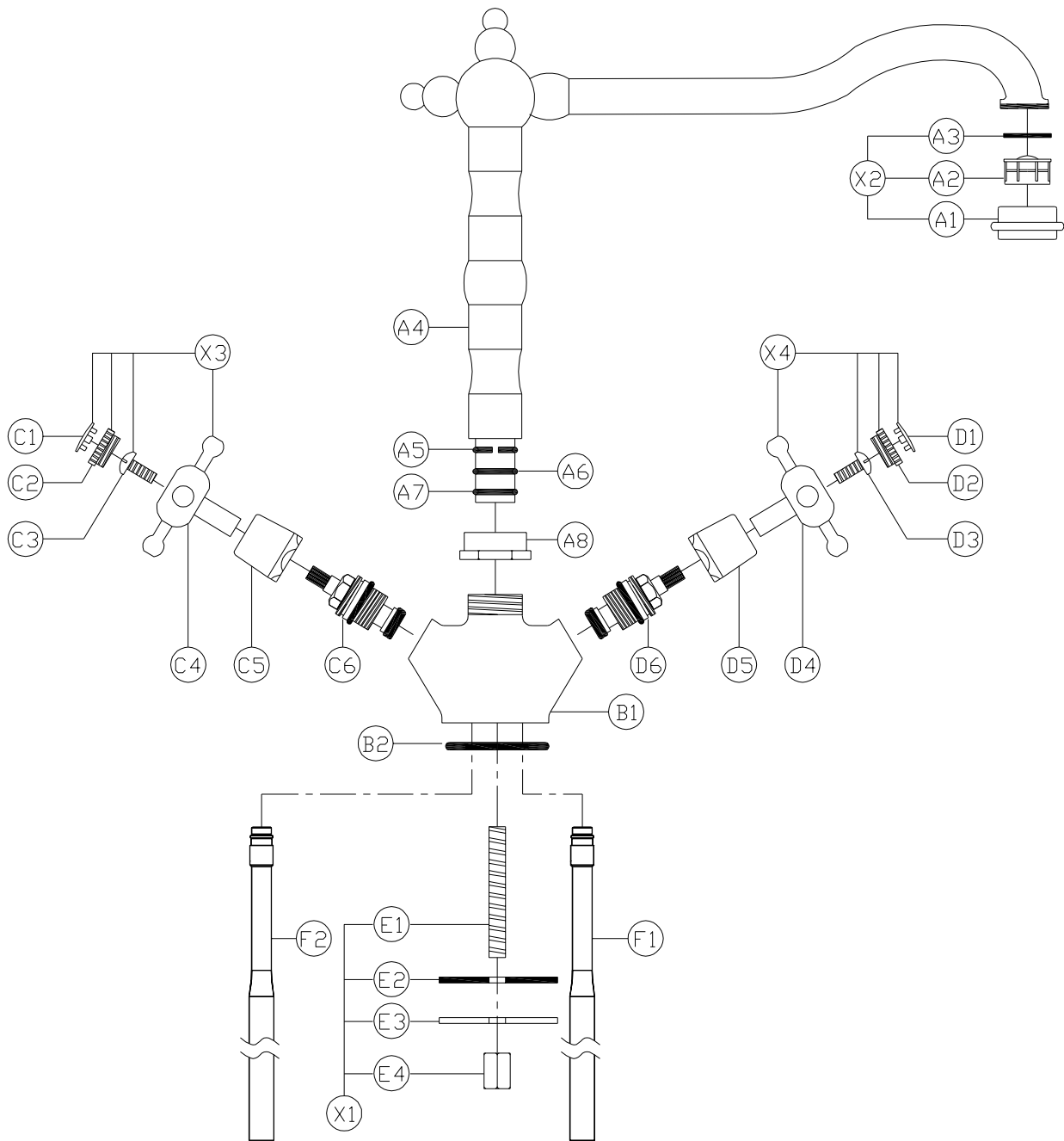

TAP3801/3811 - Antique style service drawing v2

(c) abode home products ltd
www.abode.eu

our policy is to continually improve and develop products, and accordingly we reserve the right to amend specifications without prior notice

General Advice:

- These instructions are intended as a guide only, if you are in any doubt you should seek the advice of a qualified professional.
- Take care not to mark finished parts with screwdrivers or other tools.
- Use a pair of rubber gloves to get a better grip on decorative hand tight parts.
- Ensure all parts are reassembled tightly.
- After maintenance test that all assemblies are water tight and function correctly.
- Always isolate the hot and cold water supplies before starting any maintenance, once isolated you should drain any residual water from your system.

To replace the hot valve:

1. Unscrew the indicies / dust cap (C1 & C2) by hand.
2. Unscrew the crosshead screw (C3)
3. Pull the handle (C4) away from the tap body.
4. Holding the tap body (B1) unscrew the valve (C6) using a 17mm ring spanner or adjustable wrench.
5. Clean any debris from the chamber in the tap body (B1).
6. Reassemble the tap in the reverse order.

To replace the spout o-rings:

1. Whilst holding body (B1) unscrew the spout locking collar (A8)
2. Pull the spout (A4) vertically away from the body (B1).
3. Remove the old o-rings (A6 & A7) using a small screwdriver or similar.
4. If worn, remove the white PTFE spacer (A5).
5. Ensure the inside of the body (B1) and the spout base is clean of dirt and grit with a soft wet cloth.
6. If required locate the new white PTFE spacer (A5).
7. Carefully locate the new O-rings (A6 & A7) onto the spout base.
8. Grease the O-rings (A6 & A7) thoroughly with silicone or alternative similar grease.
9. Reassemble the tap in the reverse order.